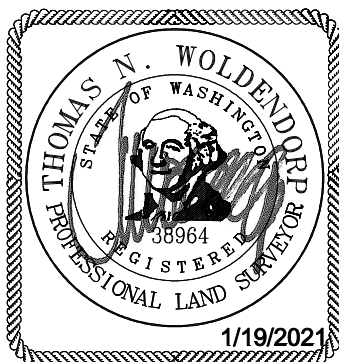

EXHIBIT A LEGAL DESCRIPTION

EASEMENT LEGAL DESCRIPTION

TTHE NORTH 25 FEET OF THE EAST 3 FEET OF THE FOLLOWING DESCRIBED TRACT OF LAND;
THAT PORTION OF THE SOUTH 100 FEET OF THE NORTH 700 FEET OF GOVERNMENT LOT 1, SECTION 19, TOWNSHIP 24 NORTH, RANGE 5 EAST, WILLAMETTE MERIDIAN, IN KING COUNTY, WASHINGTON, LYING WEST OF EAST MERCER WAY; EXCEPT THAT PORTION THEREOF LYING WEST OF A LINE BEGINNING AT A POINT ON THE SOUTH LINE OF THE NORTH 700 FEET OF SAID GOVERNMENT LOT 1, WHICH BEARS SOUTH 89 DEGREES 46'00" EAST ON SAID SOUTH LINE A DISTANCE OF 543.09 FEET FROM THE WEST LINE OF SAID GOVERNMENT LOT 1; THENCE NORTH 15 DEGREES 20'00" WEST 103.69 FEET TO THE TERMINUS OF THE LINE.

SITUATE IN THE CITY OF MERCER ISLAND, THE COUNTY OF KING, STATE OF WASHINGTON.



SITE PROJECT # 18-233

PAGE ___ OF ___