

5003
 1
 100276 7722060812 - A M
 100-4-77

DEC 6 2 39 PM '77

NOTICE OF ADDITIONAL
TAP OR CONNECTION CHARGES

RECORDED KC RECORDS

In compliance with Chapter 72, Laws of 1977 Regular Session, Chapter 65.08 RCW, the City of Mercer Island has levied, or may levy in the future, a charge on property pertaining to;

- a.) the amount required by the provisions of a contract pursuant to RCW 35.91.020 under which the water or sewer facilities so tapped into or used were constructed; or
- b.) any connection charges which are in fact reimbursement for the cost of facilities constructed by the sale of revenue bonds; or
- c.) the additional connection charge authorized in RCW 35.92.025.

These amounts and charges have been, or will be, levied against the following described property located in King County, Washington;

Mercer Island, Washington, an island located in Lake Washington, encompassing 4,127 acres; defined as consisting of a portion of all of the following described sections and government lots in Township 24, Range 4 E., W.M. and Township 24, Range 5 E, W.M.:

Government Lot	Quarter Section	Section	Township	Range
1	SE $\frac{1}{4}$	2	24	4 East, W.M.
3, 4, 5 & 6	SW $\frac{1}{4}$	1	24	4 East, W.M.
1 & 2	SE $\frac{1}{4}$	1	24	4 East, W.M.
1 & 2	NW $\frac{1}{4}$	11	24	4 East, W.M.
1, 2 & 3	NW $\frac{1}{4}$, NE $\frac{1}{4}$ & SE $\frac{1}{4}$	12	24	4 East, W.M.
and the remainder of the	SW $\frac{1}{4}$	12	24	4 East, W.M.
1	SW $\frac{1}{4}$	12	24	4 East, W.M.
2 & 3	NW $\frac{1}{4}$	11	24	4 East, W.M.
and the remainder of the	NE $\frac{1}{4}$	13	24	4 East, W.M.
4 & 5	NE $\frac{1}{4}$	13	24	4 East, W.M.
6 & 7	SE $\frac{1}{4}$	13	24	4 East, W.M.
4 & 5	NE $\frac{1}{4}$	24	24	4 East, W.M.
and the remainder of the	SE $\frac{1}{4}$	24	24	4 East, W.M.
Portion of 1 and all of 3	SE $\frac{1}{4}$	24	24	4 East, W.M.
Portion of 1 and all of 2	NW $\frac{1}{4}$	25	24	4 East, W.M.
and the remainder of the	NE $\frac{1}{4}$	25	24	4 East, W.M.
4 & 5	NE $\frac{1}{4}$	25	24	4 East, W.M.
Portion of 1	SW $\frac{1}{4}$	25	24	4 East, W.M.
Portion of 1 and all of 2 & 3	SW $\frac{1}{4}$	25	24	4 East, W.M.
6	NW $\frac{1}{4}$	36	24	4 East, W.M.
1, 2 & 3	NE $\frac{1}{4}$	36	24	4 East, W.M.
Portion of 4	SW $\frac{1}{4}$	6	24	5 East, W.M.
Portion of 4 and all of 5	NW $\frac{1}{4}$	7	24	5 East, W.M.
and the remainder of the	NW $\frac{1}{4}$	7	24	5 East, W.M.
10 & 11	SW $\frac{1}{4}$	7	24	5 East, W.M.
1	SE $\frac{1}{4}$	7	24	5 East, W.M.
and the remainder of the	SE $\frac{1}{4}$	7	24	5 East, W.M.
2 & 3	SW $\frac{1}{4}$	8	24	5 East, W.M.
and the remainder of the	NW $\frac{1}{4}$ & SW $\frac{1}{4}$	18	24	5 East, W.M.
1	NE $\frac{1}{4}$	18	24	5 East, W.M.
and the remainder of the	NE $\frac{1}{4}$	18	24	5 East, W.M.
2 & 3	SE $\frac{1}{4}$	18	24	5 East, W.M.
and the remainder of the	SE $\frac{1}{4}$	18	24	5 East, W.M.
1	NW $\frac{1}{4}$	17	24	5 East, W.M.

7712060812

Government Lot	Quarter Section	Section	Township	Range
	NW $\frac{1}{4}$ & SW $\frac{1}{4}$	19	24	5 East, W.M.
1 & 2	NE $\frac{1}{4}$	19	24	5 East, W.M.
3 & 4	SE $\frac{1}{4}$	19	24	5 East, W.M.
	NW $\frac{1}{4}$	30	24	5 East, W.M.
1, 2 & 3	NE $\frac{1}{4}$	30	24	5 East, W.M.
and the remainder of the	NE $\frac{1}{4}$	30	24	5 East, W.M.
4 & 5	SE $\frac{1}{4}$	30	24	5 East, W.M.
6	SW $\frac{1}{4}$	30	24	5 East, W.M.
and the remainder of the	SW $\frac{1}{4}$	30	24	5 East, W.M.
1 & 2	NW $\frac{1}{4}$	31	24	5 East, W.M.
and the remainder of the	NW $\frac{1}{4}$	31	24	5 East, W.M.

All as shown and set forth on the map, Exhibit "A", attached hereto and made a part of this document.

Dated this 5th day of December, 1977.

 Miles L. Fuller
 Director of Utilities
 City of Mercer Island

STATE OF WASHINGTON)
) ss.
 COUNTY OF KING)

On this 5th day of December, 1977, before me, the undersigned, a Notary Public in and for the State of Washington, duly commissioned and sworn personally appeared Miles L. Fuller to me known to be the individual described in and who executed the foregoing instrument, and acknowledged to me that he signed and sealed the instrument as his free and voluntary act and deed for the uses and purposes therein mentioned.

Witness my hand and official seal hereto affixed the day and year in this certificate above written.

 Notary Public in and for the State
 of Washington, residing at
Mercer Island



7712060812

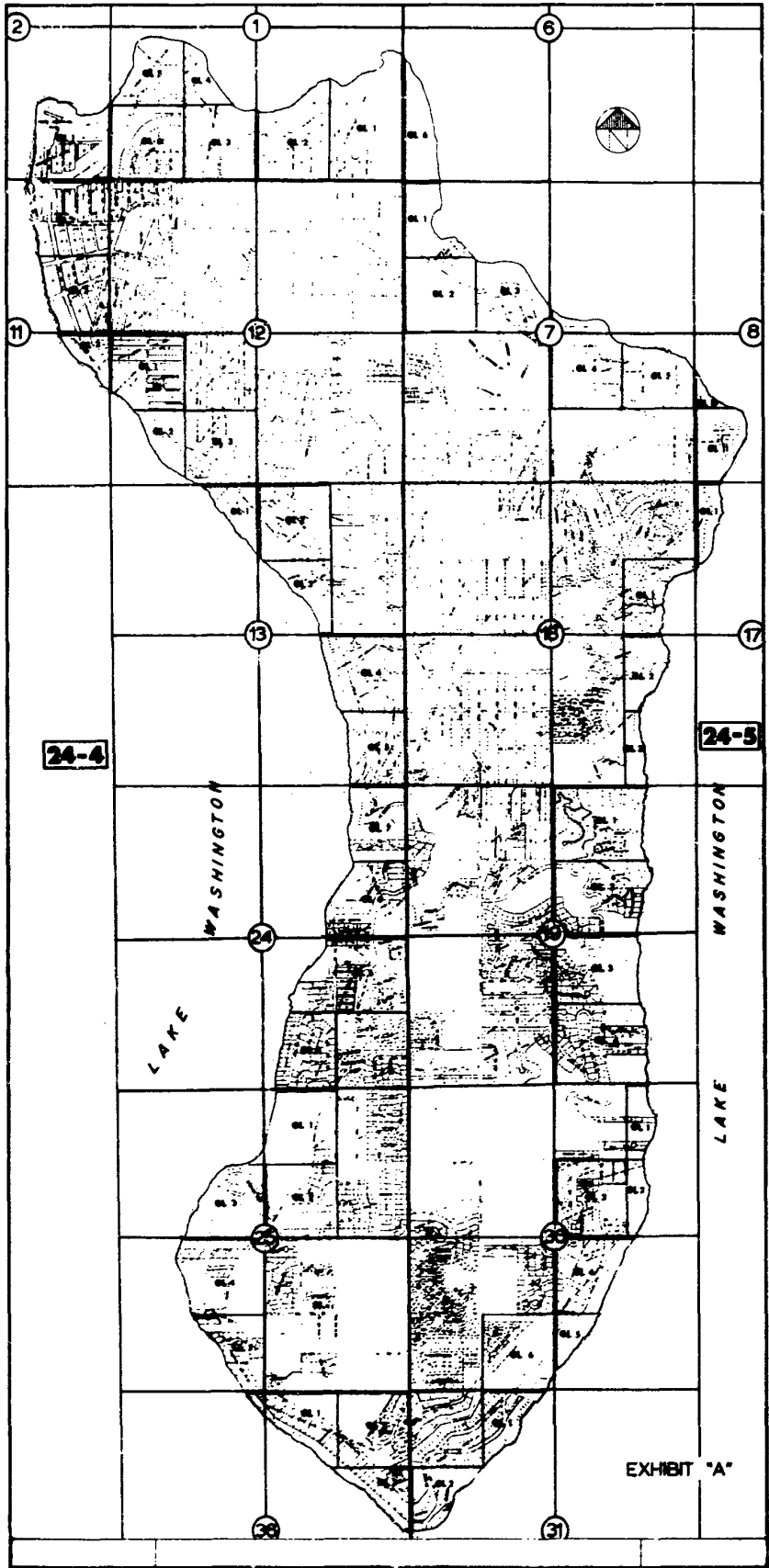

7712060812

Division of Public Health, State of Washington

FILED for Record at Request of:

Name CITY OF MERCER ISLAND

Address 3505 834th Ave

MERCER ISLAND, WA 98040