

# Site Map - Pump Station 10 Access Road Improvements

## 9036 N. Mercer Way



### Legend

- Address
- Parcels
- ▭ Buildings
- Docks
- Shoreline
- Major Roads
- Street Centerline
- Paved Road
- Paved Driveway
- Paved Parking Area
- Parks
- March 2020
- Red: Band\_1
- Green: Band\_2
- Blue: Band\_3

### Construction Keynotes

- Construct 3-inch HMA Pavement Access Road
- Bollard Chain Barrier

**ITB 23-24**

### Notes

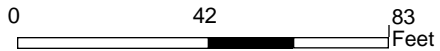

1 inch =  
83.333333333333  
feet



Disclaimer: These maps were developed by the City of Mercer Island and are intended to be a general purpose digital reference tool. These maps are not an accepted legal instrument for describing, establishing, recording or maintaining descriptions for property concerns or boundaries. The City makes no representation or warranty with respect to the accuracy or currency of these data sets, especially in regard to labeling of surveyed dimensions, or agreement with official sources such as records of survey, or mapped locations of features.

REV: 01AUG2023

# Pump Station 10 Access Road Improvements Scope of Work

## 9036 N. Mercer Way



### CROSS-SECTIONAL DETAIL A

SCALE: NTS

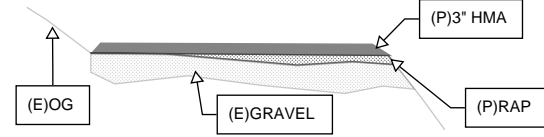

NOTE: RECYCLED ASPHALT PAVEMENT (RAP), PLACED AS NEEDED WITH EXISTING GRAVEL, 0-2", VARIABLE DEPTH FOR LEVELING. CITY TO FURNISH ALL RAP MATERIAL FOR PROJECT, 50 CY TOTAL.

### CROSS-SECTIONAL DETAIL B

SCALE: NTS

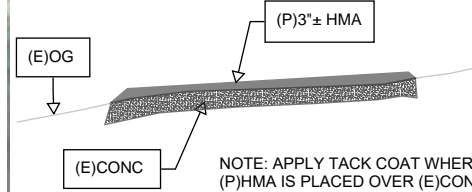

NOTE: APPLY TACK COAT WHERE (P)HMA IS PLACED OVER (E)CONC

### CROSS-SECTIONAL DETAIL C

SCALE: NTS

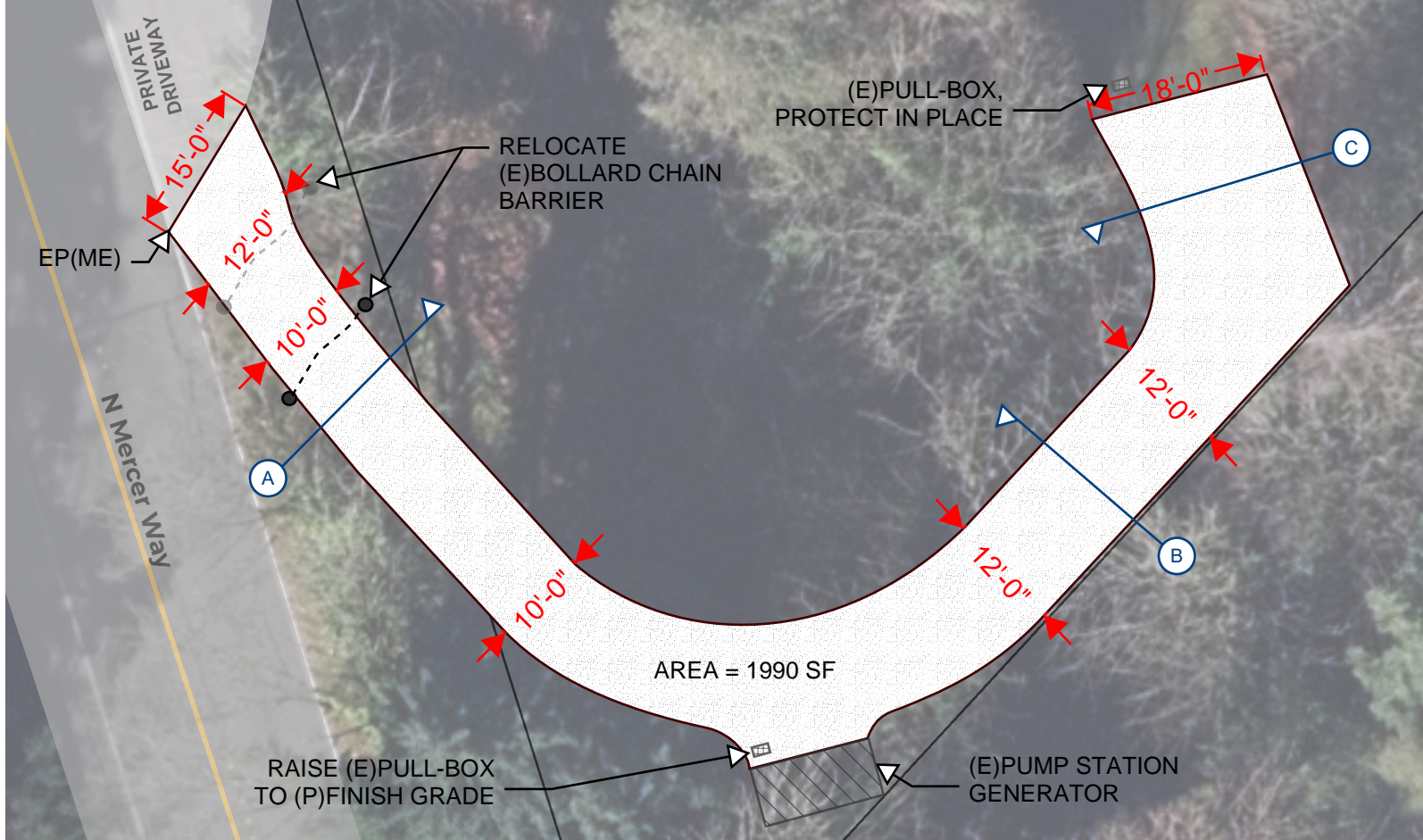
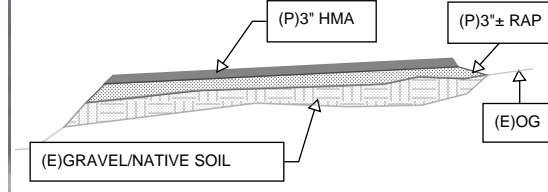

### Legend

- Address
- Parcels
- Buildings
- Docks
- Shoreline
- Major Roads
- Street Centerline
- Paved Road
- Paved Driveway
- Paved Parking Area
- Parks
- March 2020
- Red: Band\_1
- Green: Band\_2
- Blue: Band\_3

### Construction Keynotes

- Construct 3-inch HMA Pavement Access Road
- Bollard Chain Barrier

### ITB 23-24

### Notes

Locations and dimensions are approximate and are intended for bidding purposes only. Contractor shall be familiar existing conditions and scope of work prior to bid. Final placement of pavement and bollard chain barrier to be determined in the field.

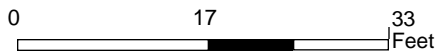

1 inch = 33.333333333333 feet



Disclaimer: These maps were developed by the City of Mercer Island and are intended to be a general purpose digital reference tool. These maps are not an accepted legal instrument for describing, establishing, recording or maintaining descriptions for property concerns or boundaries. The City makes no representation or warranty with respect to the accuracy or currency of these data sets, especially in regard to labeling of surveyed dimensions, or agreement with official sources such as records of survey, or mapped locations of features.

REV: 01AUG2023

# Existing Site Photos

REV: 01AUG2023

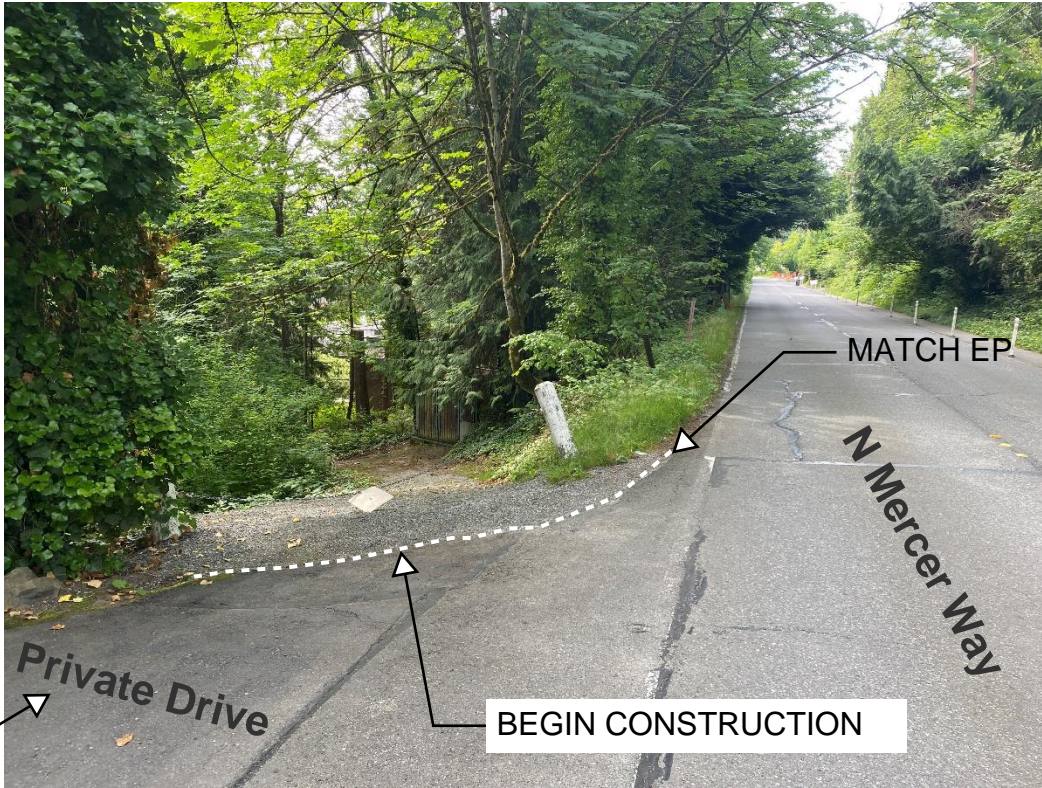

DO NOT BLOCK PRIVATE DRIVEWAY ACCESS DURING CONSTRUCTION



PAVE PER PLAN,  
VARIABLE WIDTH, 10' MIN.  
WHERE FEASIBLE











VEHICLE  
PARKING/TURNAROUND  
AREA



END CONSTRUCTION

10%±

