

PROJECT DESCRIPTION:

REPLACE WORN DECKING ON EXISTING RESIDENTIAL PIER ON LAKE WASHINGTON. WOODEN DECKING TO BE REPLACED WITH THRUFLOW GRATED PANELS. SOME PILES TO BE SLEEVED (LESS THAN 50 PERCENT OF EXISTING PILES) UPON INSPECTION WHEN EXISTING DECKING IS REMOVED. REPLACE ANY FRAMING IF NEEDED (LESS THAN 50 PERCENT OF EXISTING FRAMING) UPON INSPECTION ONCE DECKING IS REMOVED. ALL WORK TO BE DONE IN EXISTING DOCK FOOTPRINT.

PROPERTY OWNER:

RICHARD MESHER
4852 E. MERCER WAY
MERCER ISLAND, WA 98040

CONTACT:

IRWIN LAND USE CONSULTING, LLC
P.O. BOX 1715
BELLINGHAM, WA 98227
(360) 410-6745
irwinlanduse@gmail.com

LEGAL DESCRIPTION:

BEG S 89-41-00 E 1468.82 FT & S 00-11-00 W 415 FT OF N 1/4 COR OF SEC TH N 89-41-00 W 32 FT TH S 00-11-00 W 76.72 FT M/L TO BNDRY LN DESC UNDER AUD # 6153296 TH S 88-52-25 E TO SH LN TH NLY ALG SH LN TAP WCH BEARS S 89-41-00 E FR BEG TH N 89-41-00 W TO BEG & SH LDS ADJ

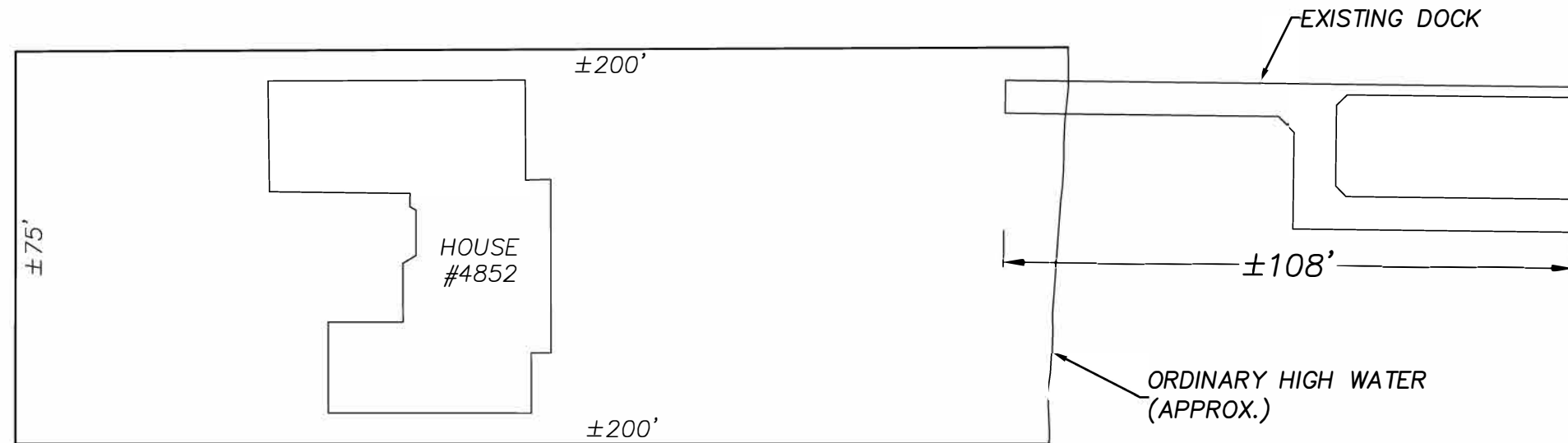
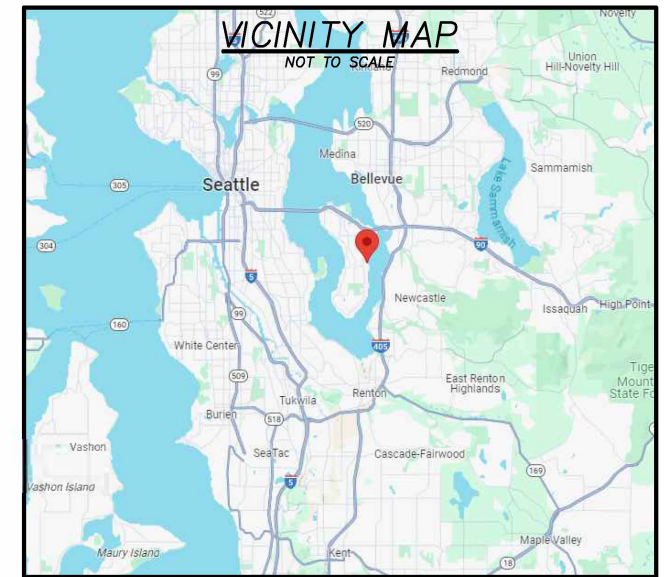
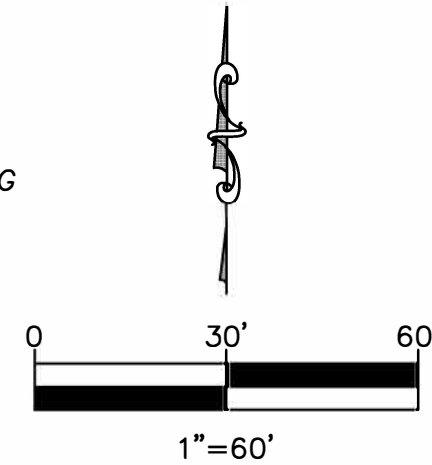

LAKE WASHINGTON

*LOT BOUNDARIES AND BUILDING LOCATIONS PER M. JOHNSON DESIGNS SITE PLAN 10.80 AND KING COUNTY ASSESSOR'S GIS DATA. DOCK DIMENSIONS, PROJECT DESCRIPTION AND WATER DEPTHS PER LAKESIDE CONSTRUCTION.



LAKESIDE CONSTRUCTION
P.O. BOX 525
ISSAQUAH, WA 98027
(206) 850-0250
sales@lakesideseattle.com

REV	DATE	BY	DESCRIPTION

MESHER
DOCK REPAIR
4852 E. MERCER WAY
MERCER ISLAND, WA 98040

PROJECT NUMBER:	2404
PARCEL NUMBER:	1924059071
ISSUE DATE:	2/13/2024

DOCK LAYOUT

SCALE: 1"=10'

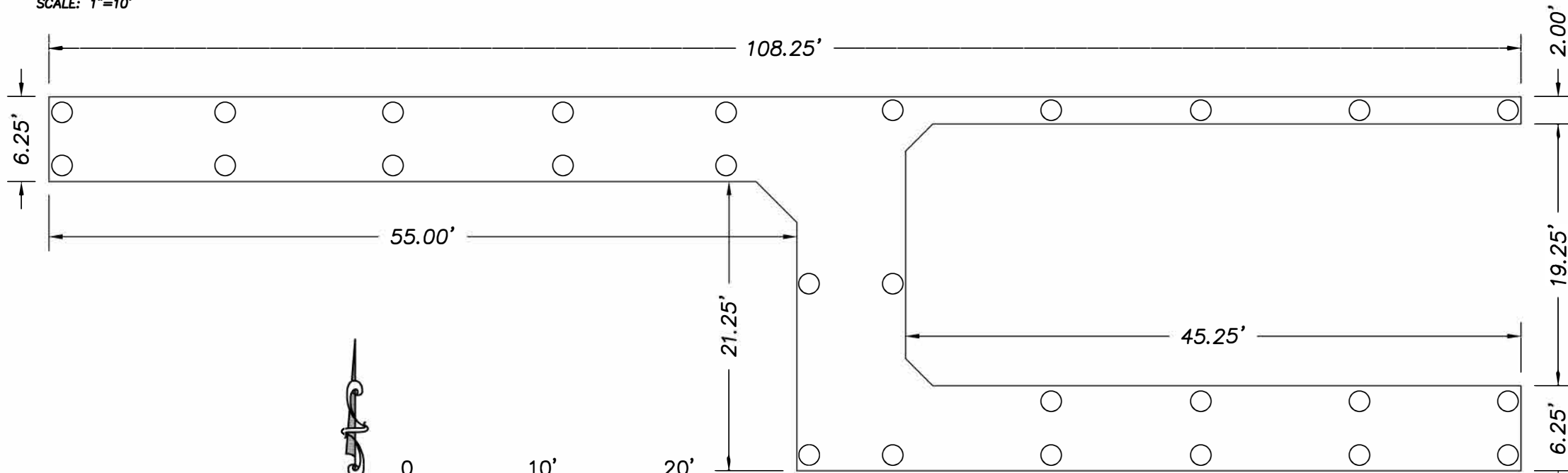

DOCK PROFILE

SCALE: 1"=10'

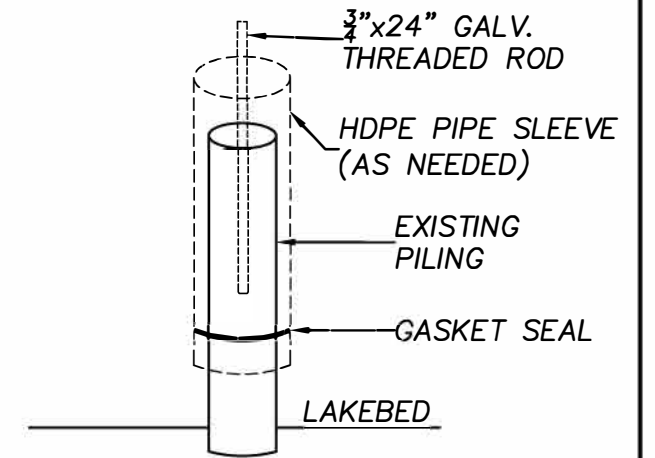
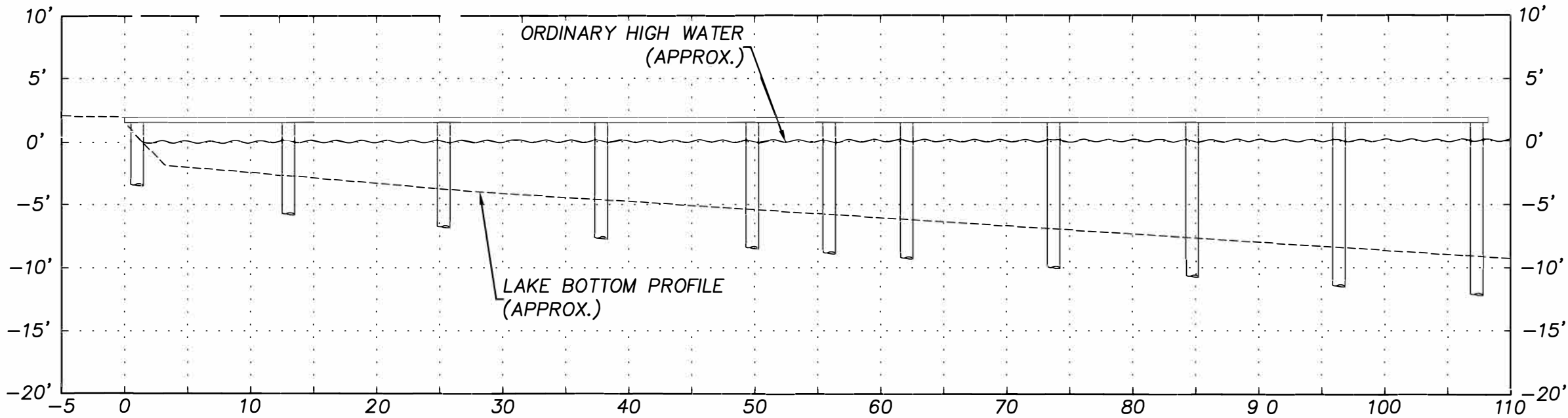

PILE SLEEVING DETAIL
NTS

ALTERNATING 1/2" x 16" GALV. THRU-BOLTS
AND 1/4" x 12" EPOXY TIMBER LOCKS

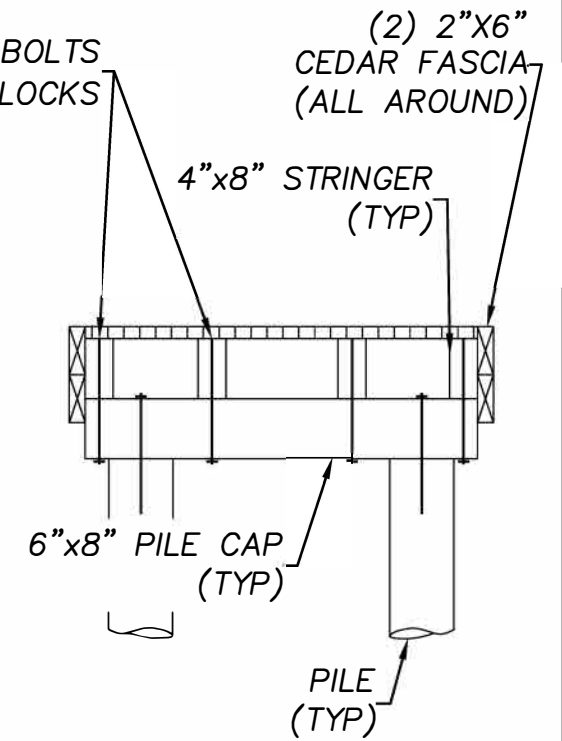

PIER END SECTION



LAKESIDE CONSTRUCTION
P.O. BOX 525
ISSAQUAH, WA 98027
(206) 850-0250
sales@lakesideseattle.com

REV	DATE	BY	DESCRIPTION

MESHER
DOCK REPAIR
4852 E. MERCER WAY
MERCER ISLAND, WA 98040

PROJECT NUMBER:	2404
PARCEL NUMBER:	1924059071
ISSUE DATE:	2/13/2024