

CITY OF MERCER ISLAND
COMMUNITY PLANNING & DEVELOPMENT
 9611 SE 36TH STREET | MERCER ISLAND, WA 98040
 PHONE: 206.275.7605 | www.mercerisland.gov
 Submit to: epermit.tech@mercerisland.gov



| CITY USE ONLY | | |
|---------------|-------------|-----|
| PERMIT # | RECEIPT # | FEE |
| | | |
| DATE RECEIVED | RECEIVED BY | |
| | | |

Non-Development Tree Permit Application

| | | | |
|--|---------|--------------------------------|-------|
| SITE ADDRESS | | | |
| PROPERTY OWNER | ADDRESS | PHONE # | EMAIL |
| APPLICANT <input type="checkbox"/> Same as Owner <input type="checkbox"/> Same as Contractor | ADDRESS | PHONE # | EMAIL |
| CONTRACTOR: <input type="checkbox"/> Same as Owner | ADDRESS | PHONE # | EMAIL |
| STATE CONTRACTORS LICENSE | | MERCER ISLAND BUSINESS LICENSE | |

Your tree contractor needs to have a City of Mercer Island Business license that they can get online through <http://bls.dor.wa.gov/>, or you need to sign the owner as contractor form prior to permit issuance.

Required Information

- Site plan of subject property showing:
 - Street Address
 - Property Lines
 - Approximate locations of existing buildings, structures, and driveways
 - Location of tree(s) to be removed relative to buildings, structures, or property lines
 - Proposed location(s) of replacement trees
- List the **species** (ie. Douglas Fir, not just fir) and **diameter** in inches (measured at 4.5' above the ground) of all trees to be cut in the space below or clearly indicate this information on the site plan.

Please answer the following questions:

- Is this tree a hazard (imminent threat to life or property)? See code 19.10.020
 - YES NO
- Has there been development (construction or exterior alteration of any buildings) in the past five years on the subject property?
 - YES NO
- Do you anticipate there will be development on the subject property in the next five years?
 - YES NO
- Are you aware of a bald eagle nest within 660 feet of this property?
 - YES NO
- Are you aware of bald eagles foraging, nesting, or roosting near this property?
 - YES NO

¹ Critical areas include steep slopes, wetlands and buffers, water courses and buffers, and bald eagles nest buffers.
 S:\CPD\FORMS\1Current Forms\Permit Apps\NonDevelopmentTreePermitApplication.docx

SPECIAL CONDITIONS

1. All work is to be done at the applicant's expense, including clean up and removal of all debris.
2. Standard safety precautions of the tree care industry are to be adhered to at all times.
3. The work is to be performed in such a way as not to do damage to any road surface, overhead or underground utilities.
4. Traffic control is the responsibility of the applicant. It is the applicant's responsibility to ensure the contractor is informed of this. If vehicles or equipment must be placed in the public right-of-way, a Right-of-Way use permit may be required.
5. The City assumes no liability in connection with this action.
6. All traffic lane restrictions and closures require a 24 hour notice to Police Dispatch at **425.577.5656**.
7. This permit is valid for three (3) years from issuance date.

NOTICE TO APPLICANT

In accepting this permit, the permittee, his successors, heirs and assigns agree to protect and hold harmless the City of Mercer Island from all claims, action or damages of every kind and description which may accrue to or suffered by any persons, corporations or property by reason of the performance of the above described work, cost of materials and labor, character of materials used or manner of installation, maintenance and operation, and in case any such suit or action is brought against said City of Mercer Island or damage arising out of or by reason of any of the above causes, the grantee, his successors, heirs or assigns will upon notice to him or them of commencement of such action, defend the same at his or their own sole expense and will fully satisfy any judgement after the said suit or action shall have finally been determined if adversely to the City of Mercer Island.

The city arborist may revoke, annul or terminate this permit if grantee fails to comply with any or all of its provisions, requirement or regulations as herein set forth or through willful or unreasonable neglect, fails to heed or comply with notices given him.

I hereby certify that I am the owner of the subject property or I have been authorized by the owner(s) of the subject property to represent this application and that I have read and examined the application and know the same to be true and correct. All provisions of laws and ordinances governing this type of work will be met whether specified herein or not. The granting of a permit does not presume to give authority to violate or cancel the provisions of any other state or local law regulating construction of the performance of construction.

Signature of Owner/Authorized Agent

Date

CITY OF MERCER ISLAND

COMMUNITY PLANNING & DEVELOPMENT

9611 SE 36TH STREET | MERCER ISLAND, WA 98040

PHONE: 206.275.7605 | www.mercerisland.gov

Inspection Requests: Online: www.mybuildingpermit.com VM: 206.275.7730



Non-Development Tree Permit Application Submittal Guide

Protecting, enhancing, and maintaining trees are key community values on Mercer Island. Removal of a tree that is not related to development (construction), requires a permit if the tree(s) to be removed

- a. Have a diameter of 10 inches or more, measured at 4.5 feet above the ground
- b. Are “exceptional”, refer to definition on page 6, or
- c. Are located in a critical area¹.

Trees that do not meet this standard (i.e. are less than 10” in diameter, etc.), do not require a permit prior to removal. To maintain tree coverage, replacement trees are also required for trees that are removed.

HOW DO I GET A TREE PERMIT?

Removal of trees that are 10” or greater in diameter but are **not** exceptional, or located in a critical area¹ require a tree permit application. Simply fill out the tree permit application (found on page 2), making sure to include a site plan with the location(s) of the trees to be removed and where replacement trees will be replanted. These permit(s) are typically issued on the same day as submitted and can be obtained at the Permit Counter.

In critical areas¹, removal of trees that are 10” or greater in diameter, or are exceptional will require a tree permit application and additional plan review. The completed application and site plan can be submitted at the permit counter. Site plans need to include location of trees to be removed and where replacement trees will be planted. Target times for tree permits that require plan review is typically two weeks. These permits usually require signature of a hold harmless/indemnification agreement. For more information on how to determine whether a tree is located in a critical area or is, considered exceptional refer to pages 5 and 6.

WHAT IF MY TREE IS A HAZARD?

Trees that pose an imminent threat to life or property, such as tree limbs or trunks that are demonstrably cracked, leaning toward overhead utility lines or structures, or are uprooted by flooding, heavy winds or storm events, still require a permit. If you have a hazard tree that needs to be removed immediately, please call us, 206-275-7605, and let us know that you will be removing the hazard tree. Take photos that depict the nature of the hazard.

After the tree has been removed a permit must be applied for within 14 days and include documentation of the hazard, either with a report from a qualified arborist or photographs. Hazard trees that are removed will still need to meet the replanting requirements.

DO I NEED A PERMIT IF I WANT TO TRIM MY TREES?

Pruning or trimming of trees up to a maximum of 25% of the total leaf area through crown thinning, crown cleaning, windowing or crown raising does not require a tree permit, unless in a critical area. Crown topping

¹ Critical areas include steep slopes, wetlands and buffers, water courses and buffers, and bald eagles nest buffers.
S:\CPD\FORMS\1Current Forms\Permit Apps\NonDevelopmentTreePermitApplication.docx

or any other trimming or pruning that is likely to result in the death or significant damage to the tree is not allowed. Trimming of trees in the right of way is not allowed.

REQUIRED INFORMATION:

1. Applicant Name
2. Street Address
3. Tax Parcel Number
4. North Arrow
5. Approximate location and dimensions of existing buildings, driveways
6. Approximate location of trees to be removed (please include distance from at least two property lines and two building corners- see drawing)
7. Approximate location of any critical areas. Refer to page 5 for information on how to determine this.
8. Number each tree, show diameter (inches at 4.5' above ground) and species
9. Locations of proposed replacement trees

INFORMATIONAL ONLY

Applicant needs to provide site plan specific to parcel. This drawing will not be accepted.

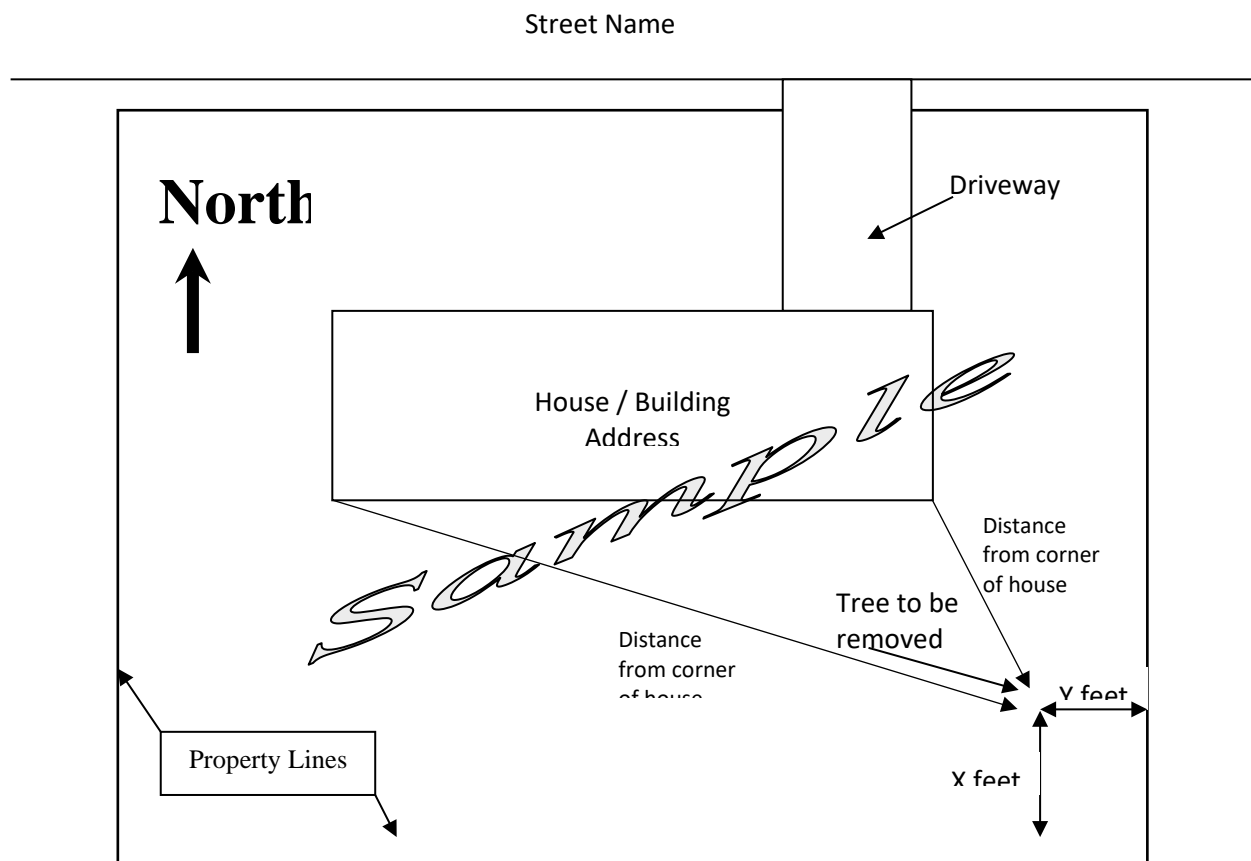

HOW DO I MEASURE THE DIAMETER OF A TREE?

Measure the circumference of the tree (the distance all the way around the trunk) at 4.5 feet above the ground and then convert the circumference to diameter. Reminder: (Diameter = Circumference ÷ 3.14)

¹ Critical areas include steep slopes, wetlands and buffers, water courses and buffers, and bald eagles nest buffers.
S:\CPD\FORMS\1Current Forms\Permit Apps\NonDevelopmentTreePermitApplication.docx

HOW MANY TREES WILL I HAVE TO REPLANT?

When trees are cut, replacement trees will need to be planted. Replacements are determined by the diameter of the trees that are removed.

| Tree Replacement Ratios | |
|---|--------------------------------------|
| Diameter of Removed Tree | Number of Replacement Trees Required |
| Less than 10 inches* (see below) | 1 |
| 10 inches up to 24 inches | 2 |
| 24 inches up to 36 inches | 3 |
| More than 36 inches and any exceptional tree(s) | 6 |

****no replacement tree is needed if the tree fits all of the following;***

Less than 10 inches in diameter, not an exceptional tree, and not a replacement tree from another tree permit. *

To ensure optimal planting conditions for tree survival, replacement trees should be planted in the wet season, October 1 – April 1.

Trees should be replaced with primary native species of the Pacific Northwest

Trees replaced need to meet these size requirements:

- a. Coniferous trees should be at least 6 feet tall
- b. Deciduous trees should have at least a 1.5 inches in diameter at the base

If smaller trees are demonstrably more suited to the species, on site conditions, or neighborhood character the City Arborist may authorize the planting of smaller sized replacement trees.

Planting of shrubs or bushes do not qualify as replacement of trees.

FEE-IN-LIEU

If the City Arborist determines that there is insufficient area to replant trees either on the site or in the adjacent public-right-of-way, the arborist may authorize the payment of a fee-in-lieu.

The fee-in-lieu amount is based upon the expected tree replacement cost, including labor, materials, and maintenance for each replacement tree, and the Council of Tree and Landscape Appraisers Guide for Plant Appraisal.

HOW DO I KNOW IF MY TREE IS LOCATED IN A CRITICAL AREA?

Click [here](#) to find out more information regarding if your property has critical areas. Just type in your address in the upper left-hand corner of the map in the address box and you will see a map of your property and the surrounding area. Refer to the map legend for critical areas.

HOW MANY TREES DO I HAVE TO RETAIN?

If you are planning on developing (building or rebuilding) your property in the next five years, a minimum of 30% of the total trees with a diameter of 10" or greater and exceptional trees must be retained over a rolling five year period.

Please note: If tree retention requirements are not met, development of the property may be delayed until compliance with tree retention requirements are met. A tree inventory prepared prior to removing any trees is a helpful way to know where your tree retention is.

WHAT IS A TREE INVENTORY?

A tree inventory is a report compiled by a qualified arborist for your property that provides:

¹ Critical areas include steep slopes, wetlands and buffers, water courses and buffers, and bald eagles nest buffers.
S:\CPD\FORMS\1Current Forms\Permit Apps\NonDevelopmentTreePermitApplication.docx

- a. Tree Species
- b. Size- including diameter and height
- c. Crown Width
- d. Overall Condition- including health and maintenance needs, overcrowding, possible problems, presence or absence of insects or diseases.
- e. Characters of the site such as soil type and condition, root space and safety should also be listed

CHOOSING A QUALIFIED ARBORIST

Hiring an arborist is a decision that should not be taken lightly. ISA certification indicates the individual has passed ISA’s extensive examination on all aspects of tree care and maintenance. Hiring a qualified arborist is an investment in your property. Refer to the [ISA website](#) for more information. Qualified arborists as defined by MICC 19.16 have relevant education and training in arboriculture or urban forestry, having the International Society of Arboriculture (ISA) Tree Risk Assessment Qualification and at least one (1) of the following credentials:

- a. ISA Certified Arborist;
- b. ISA Certified Arborist Municipal Specialist;
- c. ISA Board Certified Master Arborist;
- d. American Society of Consulting Arborists (ASCA) registered Consulting Arborist;
- e. Society of American Foresters (SAF) Certified Forester for Forest Management Plans;

WHAT ARE EXCEPTIONAL TREES?

An exceptional tree is a tree that is rare or exceptional by virtue of its size, species, condition, cultural/historical importance, age, and/or contribution as part of a tree grove. They have a diameter of more than 36 inches, or with a diameter that is equal to or greater than the diameter for the species listed in the following Exceptional Tree List.

EXCEPTIONAL TREE LIST

| Native Species | | | |
|-----------------------------|-----------|-------------------------------|-----------|
| Species | Diameter | Species | Diameter |
| Oregon Ash | 24 inches | Western Hemlock | 24 inches |
| Quaking Aspen | 12 inches | Pacific Madrone | 6 inches |
| Paper Birch | 20 inches | Big Leaf Maple | 30 inches |
| Cascara | 8 inches | Dwarf or Rocky Mountain Maple | 6 inches |
| Western Red Cedar | 30 inches | Vine Maple | 8 inches |
| Pacific Crabapple | 12 inches | Oregon White or Garry Oak | 6 inches |
| Pacific Dogwood | 6 inches | Lodgepole Pine | 6 inches |
| Douglas Fir | 30 inches | Shore Pine | 12 inches |
| Grand Fir | 24 inches | Western White Pine | 24 inches |
| Black Hawthorn | 6 inches | Western Serviceberry | 6 inches |
| Sitka Spruce | 6 inches | Pacific Yew | 6 inches |
| Willow (all native species) | 8 inches | | |

¹ Critical areas include steep slopes, wetlands and buffers, water courses and buffers, and bald eagles nest buffers.
S:\CPD\FORMS\1Current Forms\Permit Apps\NonDevelopmentTreePermitApplication.docx

| Non-Native Species | | | |
|---------------------------|-----------------|---------------------------------|-----------------|
| Species | Diameter | Species | Diameter |
| Orchard (Common) Apple | 20 inches | English Elm | 30 inches |
| European Ash | 22 inches | Gingko | 24 inches |
| Green Ash | 30 inches | Common Hawthorn | 16 inches |
| Raywood Ash | 24 inches | Washington Hawthorn | 9 inches |
| European Beech | 30 inches | European Hornbeam | 16 inches |
| European White Birch | 24 inches | Katsura | 30 inches |
| Atlas Cedar | 30 inches | Littleleaf Linden | 30 inches |
| Deodor Cedar | 30 inches | Honey Locust | 20 inches |
| Incense Cedar | 30 inches | Southern Magnolia | 16 inches |
| Flowering Cherry | 23 inches | Paperbark Maple | 12 inches |
| Lawson Cypress | 30 inches | Japanese Maple | 12 inches |
| Kousa Dogwood | 12 inches | Red Maple | 25 inches |
| Eastern Dogwood | 12 inches | Sugar Maple | 30 inches |
| American Elm | 30 inches | Ponderosa Pine | 30 inches |
| Sycamore Maple | 24 inches | Scot's Pine | 24 inches |
| Monkey Puzzle Tree | 22 inches | London Plane | 30 inches |
| Mountain-Ash | 29 inches | Flowering Plum | 21 inches |
| Pin Oak | 30 inches | Costal Redwood | 30 inches |
| Red Oak | 30 inches | Giant Sequoia | 30 inches |
| Callery Pear | 13 inches | Japanese Snowbell | 12 inches |
| Austrian Black Pine | 24 inches | Tulip Tree | 30 inches |
| American Sweetgum | 27 inches | Willow (All non-native species) | 24 inches |

¹ Critical areas include steep slopes, wetlands and buffers, water courses and buffers, and bald eagles nest buffers.
S:\CPD\FORMS\1Current Forms\Permit Apps\NonDevelopmentTreePermitApplication.docx